

SUNLOUNGER TIMER

ST100

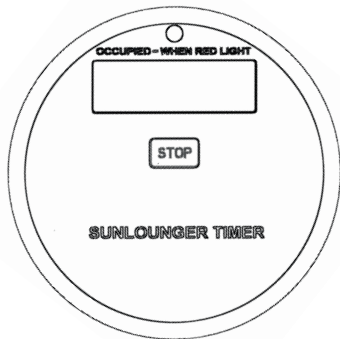

The towel war is over

USER MANUAL / ENGLISH

Introduction

Dear Customer,

Thank you for using Sunlounger Timer.

This product complies with statutory European and American requirements.

To maintain this status and to ensure safe operation, you as the user must observe these operating instructions!

These operating instructions are part of this product. They contain important notes on commissioning and handling. Also consider this if you pass on the product to any third party.

Therefore, retain these operating instructions for reference!

All company names and product names are trademarks of their respective owners. All rights reserved.



Unit

Bolts

Mounting plate

Rubber seal

Sunlounger Timer

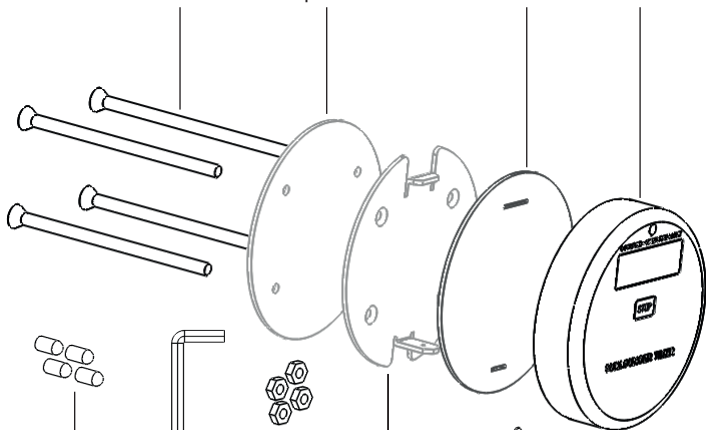

Bolt caps

Hex key

Nuts

Adapter plate

Battery cover & screw

Locking screw

Getting Started

1. Take out the battery cover and place 2 x AA batteries.
2. The Sunlounger Timer is now operational.
3. Setup the current time, operation time and countdown time:



- Press and hold "M" to enter/exit settings
- Press "M" to switch between hours and minutes
- Press "+" or "-" to switch between setting modes
- Press "+" or "-" to setup the time data

Setting modes:

- Current time = real time at your location
- Countdown = countdown time when occupied
- Start time = when should the device be active
- End time = when should the device go on standby

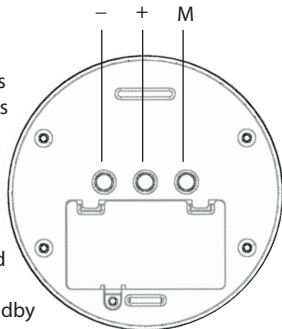

Mounting

1. Depending on the type of chair and mattress, you might need to drill 4 holes to mount the unit*.
2. Place the “adapter plate” on the front, “mounting plate” on the back and get the “bolts” through.
3. Cut the lenght of the bolts if needed. Cut only bolts where there is no thread!
4. Tight it all together by using the nuts and cover with bolt caps.
5. Add the “Rubber seal” on top of the “adapter plate”.

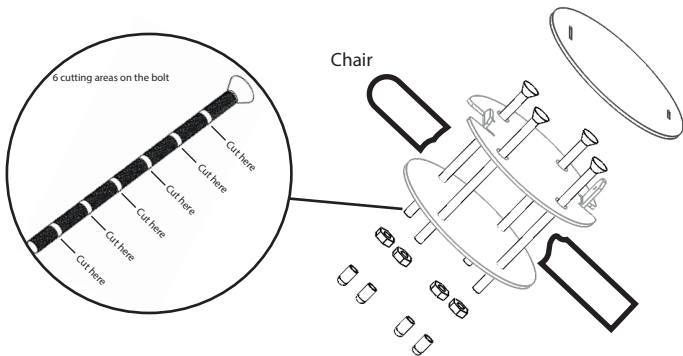

*Warning: mounting the device as described is the responsibility of the user.
Sunlounger Timer is NOT responsible for the modifications made on the chair/bed/mattress

Lock the device

1. Place the Sunlounger Timer on top of the "adapter plate" and "rubber seal".
2. And lock by tightening the "lock screw" with the "hex key".



Using the Sunlounger Timer

1. LED light will flash blue when the device detect vibration.
2. LED light will flash red when its occupied.
3. The "Battery icon" will flash when the battery level is low.
4. The user can press "STOP" when done using the chair.

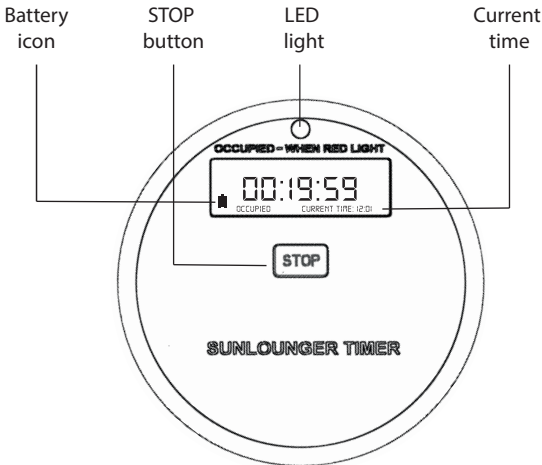

Technical Specification

- Countdown display format: 24-Hour Time
- 6-digit display for time countdown
- Battery: 2 x AA batteries (not included)
- Battery life (standby): more than 2380 hours
- Battery life (vibration): more than 700 hours
- Battery life (average usage): more than 250 days
- Battery icon starts flashing when 30% is left
- Working temperature range: -30-70°C / -22-158°F
- Weather proof / water resistant
- Materials: Aluminum, rubber, stainless steel and electronics.

Intended use

The Sunlounger Timer is intended to only be used with the matching application. Any other use than that described above can damage the product. Additionally no part of this product must be modified or converted! Read these operating instructions completely and attentively; they contain a lot of important information on setup, function and operation. Always observe the safety information!

Safety

The warranty/guarantee will expire if damage is incurred resulting from non-compliance with these operating instructions. We do not assume any liability for consequential damage! Nor do we assume any liability damage to property or personal injury caused by improper use or failure to observe the safety information. In such cases the guarantee/warranty will expire!

The following safety information is intended not only for the protection of your health but also for the protection of the device. Please read the following items carefully:

The authorized conversation and/or modification of the product is inadmissible for safety and approval reasons (CE).

The product is for outdoor usage and is water resistant and NOT waterproof. Do not place the device in liquids or place any objects on the device.

Be aware that the Sunlounger Timer surface can be hot and can cause skin burns in sunny days.

Do not place any open sources of fire, such as burning candles on the device. Handle the product with care. It can be damaged by impact, blows or when dropped even from a low height.

The product is not a toy and not suitable for children. Children cannot judge the dangers involved when handling electrical devices.

Do not leave packing material unattended, it may become a dangerous toy for children. Also observe the safety and operating instructions of the tooling used to mount the product. Mounting the device as described is the responsibility of the user. Sunlounger Timer is NOT responsible for any modifications made on any object.

Disposal

Product: Electronic devices are recyclable waste and must not be disposed of in the household waste! At the end of its service life, dispose of the product according to the relevant statutory regulations. Remove any inserted batteries/rechargeable batteries and dispose of them separately from the product.

Batteries/rechargeable batteries: You as the end user are required by law (Battery Ordinance) to return all used batteries/rechargeable batteries. Disposing of them in household waste is prohibited! Batteries/rechargeable batteries that contain any hazardous substances are labeled with the adjacent icon to indicate that disposal in domestic waste is forbidden. The descriptions for the respective heavy metals are: Cd=cadmium, Hg=mercury, Pb=lead (the names are indicated on the battery/rechargeable battery e.g. below the rubbish bin symbol). You may return used batteries/rechargeable batteries free of charge at the official collection points in your community, stores or wherever batteries/rechargeable batteries are sold. You thus fulfill your statutory obligations and contribute to the protection of the environment.

Maintenance and cleaning

Servicing or repair must only be carried out by a specialist workshop.

The product contains no parts that require servicing by you, except for the batteries and mounting process as described. Therefore never open the product (except for the procedures described in these operating instructions for insertion/replacing the batteries and mounting the device on objects).

A dry, soft and clean cloth is sufficient for cleaning the outside. Do not push the display too strongly, as this will lead to scratches or damages.

Never use any aggressive cleaning agents, alcohol or other chemical solutions that would damage the casing (discoloration).

Contact

E-mail: info@sunloungertimer.com

Phone number: +45 6170 1198



www.sunloungertimer.com